

## Grease separator EasyClean ground Multi, NS 4, Direct, 720-960 mm, D, lh

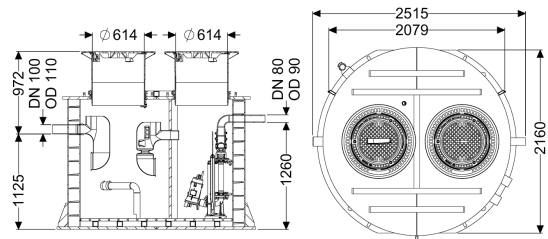

### Article information

Item no.: 96004.80D-DL  
 GTIN: 4026092098523  
 Price group: 60

### Advantages

- Low odour and clean disposal
- Defined disposal point
- Complete emptying of the separator

### Description

The unit for an underground installation combines a separator for greasy wastewater incl. sludge trap, a sampling system and a pumping station. The tank of all system parts is made of permanently resistant polymer (PE). The individual system parts can be accessed for cleaning and maintenance work via two service access covers. A direct disposal pipe socket is available for reduced odour during manual disposal. The pumping station is equipped with two submersible pumps and a backflow preventer. The submersible pumps are placed in the tank using guide rods. The pumps are actuated via a level sensor. The station is controlled by a user-friendly control unit, which can be connected to the building control system via a potential-free contact. Alternatively, alarm and collective fault messages can be sent by way of a GSM interface. A load distribution slab must be installed on site for load class D. The reinforcement drawings are available from KESSEL. 20 year polyethylene warranty.

#### Variant

Direction of flow:	left
Chamber system:	Twin walled re-enforced pipe chamber
Disposal variant:	Direct
Shredder-Mix-System:	no
Nominal size (NS):	4,00
SonicControl:	no
Disposal system:	Disposal connection
Type of disposal:	manual with suction hose

Load-bearing capacity (DIN 19901):	E2
Dimensions	
Net weight:	1060 kg
Gross weight:	1114 kg
Groundwater resistant from lower edge of base section:	2085 mm
Installation depth:	720 - 960 mm
Length:	2160 mm
Width:	2505 mm
Packaging dimension:	length
Packaging dimension:	width
Packaging dimension:	height
Tank/drain body	
Pressure pipe connection (DN):	90
Pressure pipe connection (OD):	90 mm
Distance pipe bottom outlet to tank bottom:	830 mm
Distance pipe bottom inlet to tank bottom:	1125 mm
Outlet nominal size (OD):	110 mm
Number of outlets:	1
Outlet nominal size (DN):	100 mm
Inlet nominal size (OD):	110 mm
Inlet nominal size (DN):	100 mm
Number of inlets:	1
Connection inlet/outlet sockets:	PE-HD pipes in accordance with DIN 19537, PVC-KG pipes in accordance with DIN 19534, PP or AS
Clear width of entry (LW):	600 mm
Coverage features	
Type of cover:	Cover plate
Cover material:	Grey iron
Colour of cover:	black
Height of cover:	95 mm
Locking:	unlocked
Load class:	D 400 (EN 124)
Tightness:	odour-tight and surface water resistant
Wastewater contents	
Separator contents:	1000 l
Max. grease layer thickness:	110 mm
Total volume:	1400 l
Contents of sludge trap:	400 l
Storage quantity of grease:	160 l
Pumping device	
Pump:	GTF 1400
Number of pumps:	2
Weight, pump:	12 kg
Protection class:	I

Insulation class:	H
Cos phi - power factor:	0,8
Protection class (pump):	IP 68
Max. temperature (permanent) of conveyed material:	40 °C
Max. pumping capacity:	31 m <sup>3</sup> /h
Max. pumping height:	10,5 m
Speed:	2900 U/min
Power P1:	1,5 kW
Power P2:	1,1 kW
Operating mode:	S1
Type of pump connection cable:	H07RN-F 4G 1.5 mm <sup>2</sup> mm <sup>2</sup>
Impeller type:	Multi-vane impeller
Length of mains cable for pump:	10 m
Rated current:	6,5 A
Control	
Control unit:	Comfort
Motor protection switch:	yes
Alarm sensor:	Level sensor
Level measurement instrument:	Level sensor
Type of level measurement:	hydrostatic
Protection class control unit:	IP 54
Mains frequency:	50 Hz
Operating voltage:	400 V
Potential-free contact:	yes
GSM interface:	yes
Log book function:	yes
Multi-line display:	yes
Battery buffering:	yes
Self-diagnosis system (SDS):	yes
Type of fuse required (electrical protection):	C 16 A